

BOUNDARY INFORMATION	
L-1	L-2
B = S88°51'39"W	B = N46°10'37"W
L = 7.08'	L = 16.98'

EXISTING LEGEND		PROPOSED LEGEND	
	EXISTING ASPHALT		PROPOSED ASPHALT
	EXISTING CONCRETE		PROPOSED CONCRETE
	PROPERTY LINE		PROPOSED STAMPED CONCRETE
	ADJACENT PROPERTY LINE		LANDSCAPE BUFFER
	CENTER LINE		BUILDING SETBACK
	EXISTING EASEMENT LINE		
	NON-VEHICULAR ACCESS LINE		
	FLOOD ZONE LINE		
	EXISTING OVERHEAD LINE		
	EXISTING WATER MAIN		
	EXISTING WATER SERVICE		
	EXISTING SANITARY SEWER MAIN		
	EXISTING STORM DRAIN MAIN		
	EXISTING CATCH BASIN		
	EXISTING WATER VALVE		
	EXISTING FIRE HYDRANT		
	EXISTING WATER METER		
	EXISTING SANITARY SEWER MANHOLE		
	EXISTING WOOD POWER POLE		
	EXISTING CONCRETE POWER POLE		
	EXISTING HANDHOLE		
	EXISTING GUY ANCHOR		
	EXISTING TELEPHONE MANHOLE		
	EXISTING TOPO ELEVATION		
	EXISTING TREES		

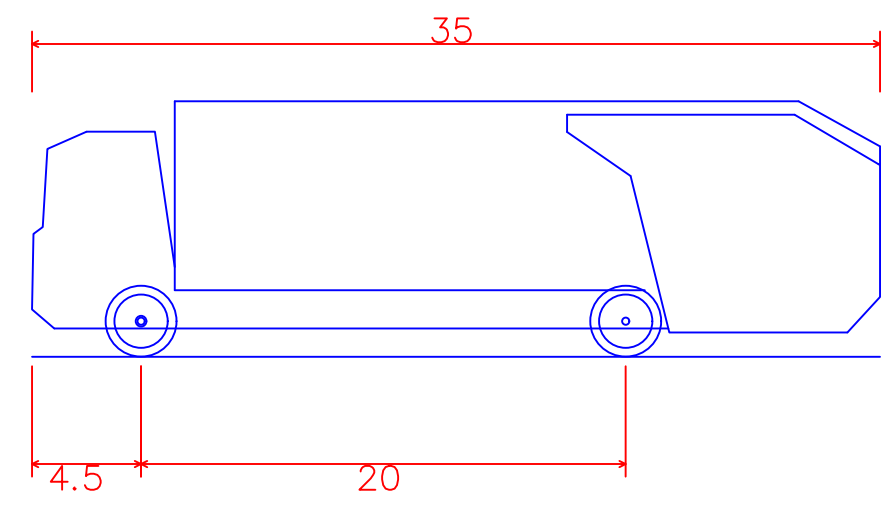

Rear-Load Garbage Truck
Overall Length 35.000ft
Overall Width 8.375ft
Overall Body Height 10.546ft
Min Body Ground Clearance 1.000ft
Track Width 8.375ft
Lock-to-lock time 6.00s
Curb to Curb Turning Radius 29.300ft

PLAN VIEW
SCALE: 1" = 20'

DRC

PZ25- 12000026
12/03/2025



Thompson Engineering
& Consulting, Inc.
19304 NW 12th Street
Pembroke Pines, FL 33029
Florida Registry No. 36359
thompson-ec.com
(954) 232-2261

Date: 10/29/2025
This item has been digitally signed and sealed by Justin Thompson, PE, on the date adjacent to the seal.
Printed copies of this document are not considered signed and sealed and the signature must be verified on any electronic copies.

DRC SUBMITTAL
RISING TIDE
CAR WASH
2901 W. ATLANTIC BOULEVARD
POMPANO BEACH, FL 33069
CITY OF POMPANO BEACH
BROWARD COUNTY

Project No.	25-032
Date	10/29/2025
Scale	As Shown
Drawn By	UCS
Checked By	JT

Revisions		
No.	Description	Date

GARBAGE TRUCK
CIRCULATION
PLAN